

UNIVERSITY OF SEOUL

Seoul International  
Summer School I (2026)



# WELCOME TO UOS!



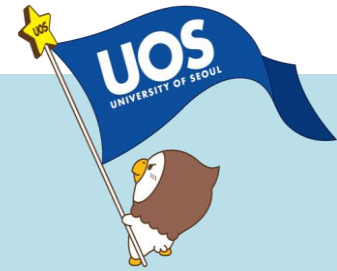

## **1. Introduction**

- **Staff Contact Details**
- **Program Calendar**
- **Checklists**

## **2. Academics**

- **Course Options**
- **Faculty & Classrooms**

## **3. Cultural Activities**

- **Field Trips**
- **PA (Peer Advocate)**
- **Discover Seoul Pass**

## **4. Campus Facilities**

- **Housing**
- **Dining Places**
- **Library**



# Seoul International Summer School Staff Contact Details

## Jihyo LEE & Yunhee AHN (Program Coordinator, SISS Team)



- Main Contact: [uossummer@uos.ac.kr](mailto:uossummer@uos.ac.kr)
- Tel: +82.02.6490.6661
- Location: #506, 5rd floor, University Center (Bldg. No.7)
- Office hour: 9 am to 6 pm (lunch hour 12 - 1 PM)



# Program Calendar

Time	SUN	MON	TUE	WED	THU	FRI	SAT
	28-Jun	29-Jun	30-Jun	01-Jul	02-Jul	03-Jul	04-Jul
09:00-12:00				Arrival Check in 	Class	Class	Design your own Seoul!
13:00-16:00			Class		Class		
16:00-18:00					Welcoming by PA		
Time	05-Jul	06-Jul	07-Jul	08-Jul	09-Jul	10-Jul	11-Jul
09:00-12:00	Design your own Seoul!	Class	Class	Class	Special Activity (Field Trip to JEONJU)		
13:00-16:00		Class	Class	Class			
Time	12-Jul	13-Jul	14-Jul	15-Jul	16-Jul	17-Jul	18-Jul
09:00-12:00		Class	Class	Class	Class	No Class ★	★
13:00-16:00		Class	Class	Class	Class		
Time	19-Jul	20-Jul	21-Jul	22-Jul	23-Jul	24-Jul	25-Jul
09:00-12:00	★	Class	Class	1-Day Field Trip	Class	Class	
13:00-16:00		Class	Class		Class	Class	
Time	26-Jul	27-Jul	28-Jul	29-Jul	30-Jul	31-Jul	01-Aug
09:00-12:00		Class	Class	Check out Departure 			
13:00-16:00		Class	Class				
16:00-18:00			Farewell by PA				

**2 Days' Field Trip to Jeonju** / **1 1-Day Field Trip** / **72-hour Discover Seoul Pass** ★



## Checklists

- **Valid Passport**
- **Airplane Tickets**
- **Travel Health Insurance**
- **K-ETA or C-3-1 Short Term Visa Document (If necessary)**
- **Personal Belongings**
- **Credit/Debit Cards and Cash**
- **Personal Medicines**



# Course Options

## Track 1 : Business in Korean Perspective

TIME	Option 1	Option 2	Option 3
Morning (9AM - 12PM)	 <p data-bbox="547 743 878 839">Korean Economy &amp; Business</p>	 <p data-bbox="1021 743 1353 839">Korean Economy &amp; Business</p>	 <p data-bbox="1514 768 1852 811">Korean Language</p>
Afternoon (1PM - 4PM)	 <p data-bbox="553 1219 872 1315">Special Topics in Global Business</p>	 <p data-bbox="1038 1229 1375 1272">Korean Language</p>	 <p data-bbox="1504 1219 1823 1315">Special Topics in Global Business</p>



# Course Options

## Track 2 : Korean Studies

TIME	Option 1	Option 2	Option 3
<p>Morning (9AM - 12PM)</p>	 <p>Contemporary Korean Society and Experiences Korean Tradition &amp; Culture</p>	 <p>Contemporary Korean Society and Experiences Korean Tradition &amp; Culture</p>	<p><b>HANGEUL</b></p>  <p>Korean Language</p>
<p>Afternoon (1PM - 4PM)</p>	 <p>Special Topics in Korean Studies</p>	<p><b>HANGEUL</b></p>  <p>Korean Language</p>	 <p>Special Topics in Korean Studies</p>



# Course Faculty

Course Name	Instructor	College / Department
Korean Economy & Business	Prof. Eugene Kim	University of Seoul, Office of International Affairs
Special Topics in Global Business	Prof. Yung Ki Kim	University of Seoul, Office of International Affairs
Special Topics in Korean Studies	Prof. Eunsoo Kim	University of Seoul, College of Business Administration
Contemporary Korean Society and Experiences	Prof. Keebom Nahm	University of Seoul, Department of Urban Sociology
Korean Language (Afternoon-1)	Soohyun Kim	University of Seoul, Korean Language & Culture Program
Korean Language (Morning & Afternoon-2)	Jiyoung Kim	University of Seoul, Korean Language & Culture Program

# Classroom Location

Course Name	Location
<b>Korean Economy &amp; Business</b>	Cheonnong Hall, Room 208
<b>Special Topics in Global Business</b>	Cheonnong Hall, Room 208
<b>Special Topics in Korean Studies</b>	Cheonnong Hall, Room 210
<b>Contemporary Korean Society and Experiences</b>	Cheonnong Hall, Room 210
<b>Korean Language (Morning)</b>	The Centennial Memorial Hall, Room 307
<b>Korean Language (Afternoon-1)</b>	The Centennial Memorial Hall, Na Dong, Room 501
<b>Korean Language (Afternoon-2)</b>	The Centennial Memorial Hall, Room 307
<b>Welcoming &amp; Farewell Party &amp; One Day Field Trip</b>	The Centennial Memorial Hall, Room 301



# Overview of Cultural Activities





# Cultural Activities 2026

## Field Trip to Jeonju (July 9 - 10)



Jeonju is a city that preserves Korean tradition and history, located in the heart of Jeollabu-do province. The Jeonju Hanok Village is a place where you can experience traditional Korean architecture and culture, with many Hanok (traditional Korean houses) preserved. In the Hanok Village, you can try wearing Hanbok and trying Korean traditional cultural activities.



## Jeonju Field Trip Itinerary (July 10)

Time	Location	Schedule
07:50 AM ~ 08:00 AM	UOS Campus, In front of Main Auditorium (#27)	Attendance Check
08:00 AM ~ 11:30 AM	Express Bus	Departure for Jeonju
11:30 AM ~ 4:00 PM	Jeonju	<ul style="list-style-type: none"><li>• Bibimbap Cooking Experience (Traditional Korean Cuisine)</li><li>• Lunch: Bibimbap</li><li>• Guided Tour of Jeonju Hanok Village</li><li>• Hanbok Experience (Traditional Korean Attire)</li></ul>
4:00 PM ~ 4:30 PM	Express Bus	Departure for Wanju
4:30 PM ~ 8:00 PM	Wanju	<ul style="list-style-type: none"><li>• Traditional Hanji Paper Experience</li><li>• Hanji Paper &amp; Craft-Making Workshop</li><li>• Dinner</li></ul>
8:30 PM	Jeonju Gloster Hotel	Hotel Check-in and Rest



## Jeonju Field Trip Itinerary (July 11)

Time	Location	Schedule
07:00 AM ~ 08:00 AM	Jeonju Gloster Hotel	Wake-up Call & Breakfast (Hotel Buffet)
09:30 AM ~ 10:10 AM	Express Bus	Departure for Geumsansa Temple
10:10 AM ~ 11:30 AM	Geumsansa Temple	Visit one of Korea's most renowned Buddhist temples <ul style="list-style-type: none"><li>• Explore the temple grounds and historic cultural heritage sites</li><li>• Mireukjeon Hall (National Treasure No. 62)</li><li>• Ten designated Treasures</li></ul>
11:30 AM ~ 12:00 PM	Express Bus	Departure for Lunch
12:00 PM ~ 1:20 PM	Restaurant	Lunch: Shabu-Shabu Buffet
1:20 PM ~ 5:00 PM	Express Bus	Return to the University of Seoul



## Cultural Activities

### Taekwondo : Korea's Traditional Martial Art (July 22)



Taekwondo is Korea's most famous traditional martial art and an official Olympic sport. It emphasizes discipline, respect, self-control, and perseverance while developing physical fitness and mental strength. You will have the opportunity to learn basic techniques, practice kicking skills, and experience Korean martial arts culture firsthand.



# Cultural Activities

## DIY Korean Name Seal Making (July 22)

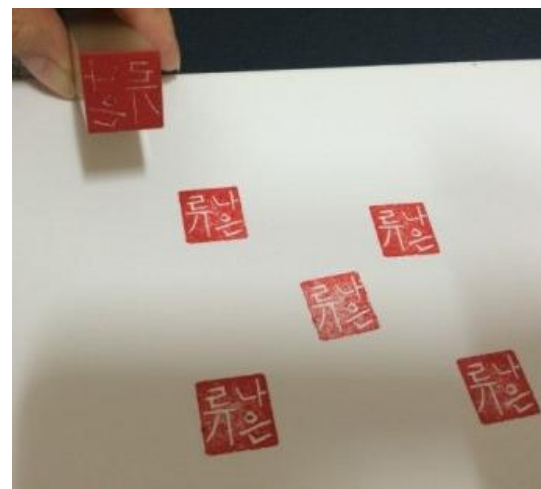

### DIY Korean Name Seal (Dojang) Making Experience

Each participant will receive a personal stone seal (1.5 cm × 1.5 cm) and learn the art of Jeongak (Seal Engraving) to carve your own Korean name seal.

### What is Jeongak (Seal Engraving)?

Jeongak is the traditional art of carving characters or designs onto a seal. The term originates from the practice of engraving Chinese seal script (Jeonseo) onto stone, wood, or other materials to create personal stamps and artistic seals.



# 1-Day Cultural Activity Itinerary (July 22)

Time	Schedule
09:50 AM	Attendance Check
10:00 AM ~ 11:30 AM	<b>DIY Korean Name Seal (Dojang) Making Experience</b>
11:30 AM ~ 12:00 PM	Individual Lunch
1:45 PM	Attendance Check
2:00 PM ~ 4:00 PM	<b>Takwondo Experience</b>
4:20 PM	Dismissal



## Cultural Activities

# Discover Seoul Pass (Design Your Own Seoul)



You can use **72h PASS CARD**

Design your own plan to Discover Seoul!

**Free entrance (more than 70 attractions)**

**Transportation card**

**Link: <https://www.discoverseoulpass.com/>**



Lotte World



Coex Aquarium



Hanbok rental(1Day)



Gyeongbokgung  
Palace



N Seoul Tower



E Cruise



Zoolung Zoolung  
Timesquare Branch



Seoul Land



## PA (Peer Advocate)



- UOS volunteer students who support your campus life
- Provide tips on campus life and living in Seoul
- Participate in the Welcome Party and Farewell Party
- May meet with you outside campus to help you adjust to life in Korea
- \* Please take a lots of photo together!



# PA (Peer Advocate)

Welcome ( July 2 ) & Farewell Session ( July 28 )





# On-campus Housing: International House

Check In : **July 1 (9:00 AM ~ 6:00 PM)**

Check Out : **July 29 ( ~ 12:00 PM)**

- If you check in after 6:00 PM on July 1, please visit the **Security Office** for a temporary check-in. You will be given your room number and other necessary information.
- Please note that you **must visit the Dormitory Office on the following day** to complete the official check-in procedure.



- There is a toilet/shower inside the house, and it is shared with your housemates.
- Bedding materials are not provided, so you need to rent/buy them or bring your own.



# On-campus Housing: International House

- Laundry Room (6 AM – 1 AM)
- Fitness Room (6 AM – 1 AM)
- Convenience Store (8 AM – 10 PM)

They are on the Residence Hall Lobby Floor.

For detailed information, refer to the UOS dormitory guidebook in English.

Dormitory Guidebook: <https://buly.kr/3NlrASu>





# Dormitory Information: How to Check-In (Dormitory Office)



# Dormitory Information: How to Check-In (Dormitory Office)

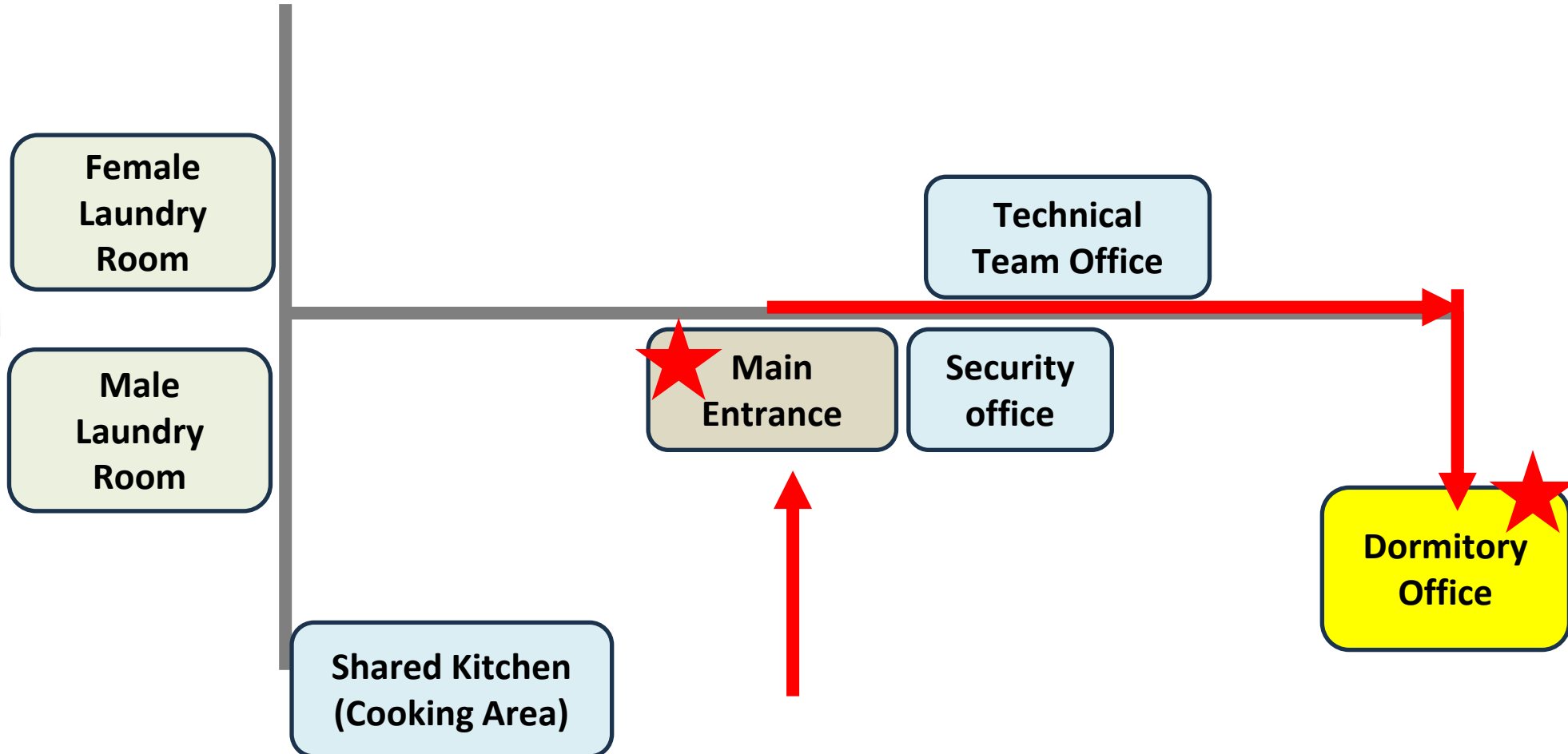

# Dormitory Information:

## How to Check-In

### **1. Visit the Dormitory Office**

When you enter the dormitory building, turn right and go straight. At the end of the hallway, turn right again. You will see the dormitory office.

### **2. Register Your Fingerprint at the Dormitory Office**

### **3. Pick up your Bedding (For students who applied for bedding service)**

Please refer to the email that bedding rental service provided (or will provide).

# Dormitory Information:

## How to Enter your Room

- Each house has a door lock (press the password) and each room needs a key to open.
- You can get a room key and a door lock password when you move-in.
- If you lose your key, you need to pay 5,000 won for reissuing a new key.

### How to Enter

- Building 102 : Press the four digit password and press \*.
- Building 103 : Follow the instructions below.



A. Press a metal bar on a bottom.



B. When a two digit number appears, Press the number in order.



C. After pressing two numbers in order, the keypad will show up. Then, press the four digit password and press \*





# Library Renovation Notice

Due to the implementation of the **Central Library Renovation Project** to ensure a safe learning environment, the operation of the Central Library will be adjusted during the summer break as outlined below. We kindly ask for your understanding regarding any inconvenience, including construction noise, during the renovation period.

- Adjustment Period: July 1 – August 31, 2026
  - Operating Hours: Weekdays: 9:00 AM – 6:00 PM
- \* Closed on weekends and public holidays

Status	Floor	Facilities
Open	2F	Information Services Room and Reading Room (including book borrowing/returns)
Open	2F	Information Desk and Academic Research Support Office
Closed	1F	Community Lounge, Study Café, Periodicals Room, Multimedia Room, Book Café
Closed	3F	Language Learning Room, Reading Room, Seminar Rooms, Study Rooms, Rest Area
Closed	4F	Thesis & Journal Reading Room, UOS Hall (Electronic Information Room), Multimedia Production Room, Career Room, Seoul Data Room, UOS Campus Room



# Library Renovation Notice

## Alternative Services

Service	Details
Interlibrary Loan & Document Delivery Services	Available through the Information Services Room (2F)
<b>Alternative Study Spaces</b>	<b>Business &amp; Economics Library (Mirae Hall 3F)</b> <b>Law School Library(Law School 5-6F)</b> <b>Centennial Memorial Library (Centennial Memorial Hall 2F)</b>
Online Academic Resources	Access to academic databases, e-journals, and e-books will remain available



# On-campus Dining Place

Weekend Notice : All dining places are closed on weekends except for those with a red-colored schedule.

The schedule is subject to change based on instructions from the administrative team.

We will provide updates if any changes occur.

Type	Name	Menu	Location (Building No.)	Operating Hours (WEEKDAYS ONLY)	
				Lunch	Dinner
Student Cafeterias	Student Cafeteria	Korean meals	Student Hall 1F (#12)	11AM ~ 2PM Snack: 3PM~ 4:50PM	5PM ~ 6:30 PM
	Natural Science Building Cafeteria	Korean meals	Natural Science Building 1F (#8)	11:30 AM ~ 2:00 PM	Not Open
	Western Cuisine	Western meals	Student Hall 2F (#12)	11:30 AM ~ 2:00 PM	Not Open
	(New) Irum Lounge	Korean meals	Centennial Memorial Hall 4F (#37)	11:30 AM ~ 2:00 PM	5:30PM ~ 6:50PM
Bakery	Paris Baguette	Bread & Drinks	Centennial Memorial Hall 3F (#37)	8:30 AM ~ 7:00 PM	
Fast food	Subway	Sandwiches	Mirae Hall 1F (#33)	10:00 AM ~ 7:00 PM	
Café	Student Hall Café	Drinks & Desserts	Student Hall 1F (#12)	8:00 AM ~ 7:00 PM	
	Cheonnong Hall Café		Cheonnong Hall 1F (#1)	8:00 AM ~ 7:00 PM SAT: 11:00 AM ~ 5:00 PM	
Convenience Store	Student Hall CU	Fast food	Student Hall B1 (#12)	8:00 AM ~ 7:30 PM	
	Student Dormitory CU	Fast food	Student Dormitory 1F (#22)	Everyday: 8:00 AM ~ 10:00 PM Unstaffed: 10:00 PM ~ 08:00 AM	



## Off-campus Dining Place



- **꽃닭 [Kkotdak]**
  - Menu : Braised spicy chicken (닭볶음탕, Dak-bokkeum-tang) and Stewed pork belly with aged kimch (삼겹김치찜, sam-gyeop-sal jjim)
- **봄솔레씨네 [Bom-sole-ssinae]**
  - Menu : Pizzas, pastas, and brunch options
- **부스부리또 [Bbus Burrito]**
  - Menu : Mexican dishes, including burritos
- **혜성칼국수(korean chopped noodle with soup) [Hyeseong Kalguksu]**
  - Menu : Chicken broth kalguksu(닭칼국수, dak kalguksu), Noodle Soup in Dried Anchovy Broth (멸치칼국수, myeolchi kaguksu)
- **은하곱창 [Eunha gopchang]**
  - Menu : Pork Small Intestine Hot Pot(돼지곱창전골, dwaeji gopchang jeongol)



**Q & A**



**Thank You**